

6 Arkwright Street, Horwich, Bolton, Lancashire, BL6 6DP



## £575 Per Month

A traditional bay fronted mid terraced on Arkwright street in the heart of Horwich. With an eclectic mix of amenities, shops, cafes and restaurants close by the property is well located. Middlebrook retail park, local train station and motor way access are also within proximity. The property boasts gas central heating and double glazed windows throughout and briefly comprises, hall, lounge, dining room, kitchen, downstairs shower room. On the upper level the landing provides access to two good size double bedrooms and a three piece bathroom suite.

- Two Bedroom
- Close to Amenities
- Deposit £663
- EPC Rating - C









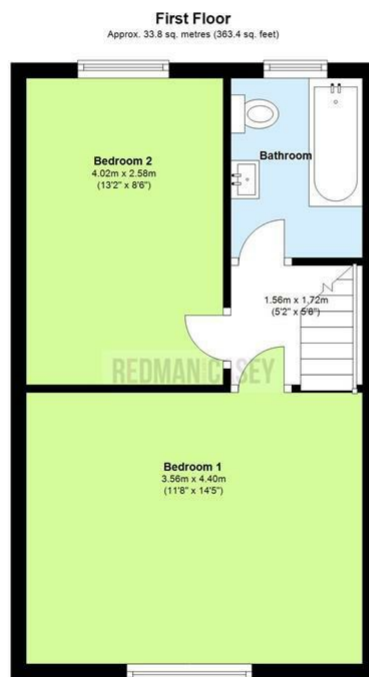
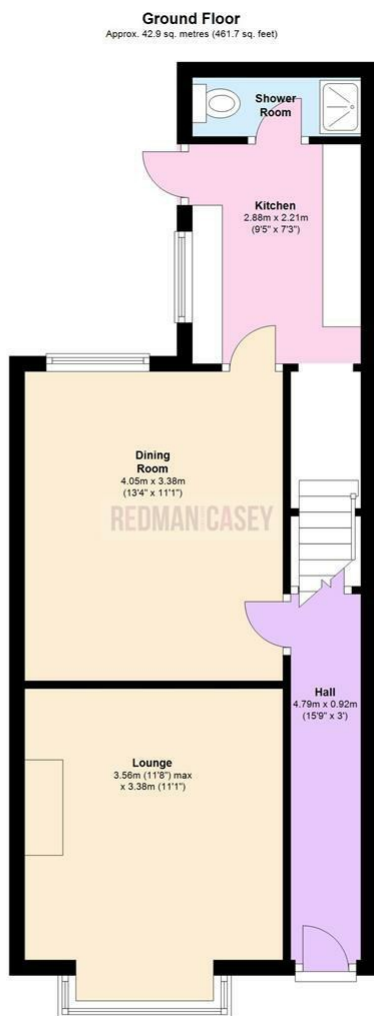

Total area: approx. 76.7 sq. metres (825.1 sq. feet)

The information provided in this brochure has been approved by the vendor, however they do not represent any form of contract and it must not be assumed that they are a final detail of what is being left in the property. The floor plans provided are a representation only and must not be relied upon for exact measurements. Please note, we have not tested any appliances or services and do not imply any warranty or guarantee unless specifically mentioned.  
Plan produced using PlanUp.

